



Netty the Newt

Design: Anne Bruvold

This pattern is free and must not be sold,
but share this file for free all you want.



You need

One shuttle, a suitable thread and two beads for eyes.

Techniques you need to know

Single shuttle split rings, the Mathew Takeda way:

<http://www.georgiaseitz.com/2009/loopsssr.html> and

http://www.youtube.com/watch?v=uQVpuZQ3h_c (video).

Loop Tatted Rings (LTR) developed by Bina Madden, which are like SSSRs without the split:

<http://www.paradisetreasures.com/pdf/teablossom.pdf>

Symbols

R	Ring
C	Chain (don't need those)
SSSR	Single shuttle split ring
LTR	Loop Tatted Ring
numbers	The number of double stitches (dst)
p	Picot
b	bead on shuttle/core thread
3-3	3 dst, picot, 3 dst
--	Long picot
----	Even longer picot
&	Twisted picot

Pattern

The beads should be on the shuttle as you start the first ring.

R₁: 8b8b8. The beads are to be on the shuttle/core thread.

R₂: 4(LTR: 3-1-1-3.)4. RW

R₃: 4(LTR: 3-1-1-3.)4. RW

Lock join through the first ring and around the thread between R₂ and R₃

SSSR: 10/10.

SSSR: 10-/10. Tiny picot between the halves

R₄: 4(LTR: 3-1-1-3.)4. RW

R₅: 4(LTR: 3-1-1-3.)4. RW

Lock join through the picot on the last SSSR and around the thread between R₄ and R₅

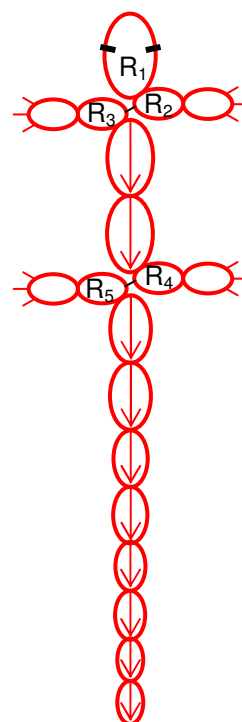

SSSR: 8/8.
 SSSR: 8/8.
 SSSR: 6/6.
 SSSR: 6/6.
 SSSR: 4/4.
 SSSR: 4/4.
 SSSR: 2/2.
 SSSR: 2/2.

By doing a SSSR rather than a ring at the tip, the thread is hidden and all you need is cut.
 At the diagram the thick black lines are the beads, the thin black beads are just to show how the legs are connected.

Some tips and how-to

Tat over the tail when doing the first ring, this way you'll hide the first end too.

If you want a longer tail, increase the number of rings starting.

Make sure you get no space between the rings. This is especially hard when making the legs.
 The lock joins will keep the legs in place.

Making LTR floating on a ring

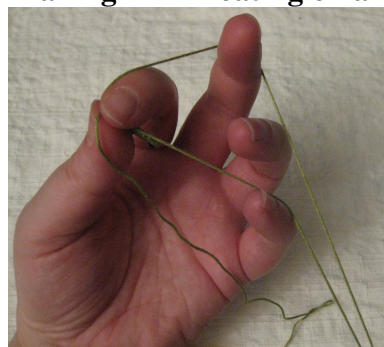

Start tatting the main ring. When you come to the point where the floating ring will be, enlarge the ring and make it large enough to make a loop. Pull the loop around the pinkie and up to the pinch. You now have two rings on your hand.

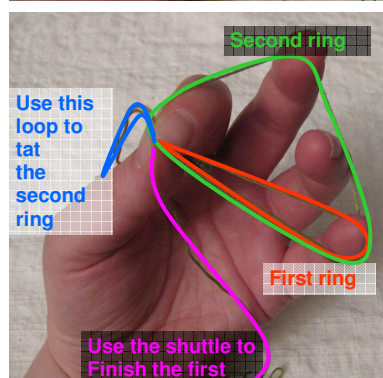

Use the loop to tat the ring and close and secure the loop the same way as when making a SSSR.



Finish the main ring.



Making Netty the Newth without loops

If you can't manage the SSSR and LTR, but do know how to do split rings (SR) and self closing mock rings (SCMR), you can still make Netty the Newth. Just replace the SSSRs by SRs and the R-LTR by SCMR an:

The beads should be on the shuttle as you start the first ring.

R₁: 8b8b8. The beads are to be on the shuttle/core thread.

SCMR₂: 4(LTR: 3-1-1-3)4. RW

SCMR₃: 4(LTR: 3-1-1-3)4. RW

Lock join through the first ring and around the thread between SCMR₂ and SCMR₃

SR: 10/10.

SR: 10/10.

SCMR₄: 4(R: 3-1-1-3.)4. RW

SCMR₅: 4(R: 3-1-1-3.)4. RW

Lock join at the top of the last SR and around the thread between SCMR₄ and SCMR₅

SR: 8/8.

SR: 8/8.

SR: 6/6.

SR: 6/6.

SR: 4/4.

SR: 4/4.

SR: 2/2.

R: 2-2.

Cut tie and hide ends.